

IMPORTANT - THIS COMMUNICATION AFFECTS YOUR PROPERTY

ENFORCEMENT NOTICE

TOWN AND COUNTRY PLANNING ACT 1990

(as amended by the Planning and Compensation Act 1991)

ISSUED BY DARTMOOR NATIONAL PARK AUTHORITY

1. THIS NOTICE is issued by the Authority because it appears to it that there has been a breach of planning control, within paragraph (a) of section 171A(1) of the above Act, at the land described below. The Authority considers that it is expedient to issue this Notice, having regard to the provisions of the development plan and to other material planning considerations. The Annex at the end of the Notice and the enclosures to which it refers contain important additional information.

2. THE LAND TO WHICH THE NOTICE RELATES

Land at The Old Quarry, Pound Lane, Bridford, in the County of Devon, as shown edged red on the attached plan.

3. THE MATTERS WHICH APPEAR TO CONSTITUTE THE BREACH OF PLANNING CONTROL

Without planning permission, the change of use of the Land from a use as a former quarry to a mixed use as a former quarry together with the siting of a mobile home used for residential purposes on the Land, in the approximate position shown marked "X" on the attached plan.

4. REASONS FOR ISSUING THIS NOTICE

It appears to the Authority that the above breach of planning control has occurred within the last ten years. The Development is contrary to the Dartmoor National Park Local Plan (First Review) Policies GP2, HS4 & HS8 and also contrary to the Devon Structure Plan (First Review) Policy C02. There are no special circumstances justifying the siting of a mobile home for residential purposes on the land and it is considered that the unauthorised use of the land adversely affects the amenity of this part of the National Park.

5. WHAT YOU ARE REQUIRED TO DO

Permanently remove the mobile home from the land and stop using any part of the land for the siting of a mobile home for residential purposes.

6. TIME FOR COMPLIANCE

You must comply within 90 days of this Notice taking effect.

7. WHEN THIS NOTICE TAKES EFFECT

This Notice takes effect on 20th December 2004, unless an appeal is made against it before that date.

Dated this 15th day of November 2004



.....
DIRECTOR OF PLANNING & COMMUNITY

Dartmoor National Park Authority
Parke, Bovey Tracey,
Newton Abbot, Devon. TQ13 9JQ

ENF/0133/99/BR - The Old Quarry, Southwood, Bridford



Compiled by J Aven on 4 November 2003

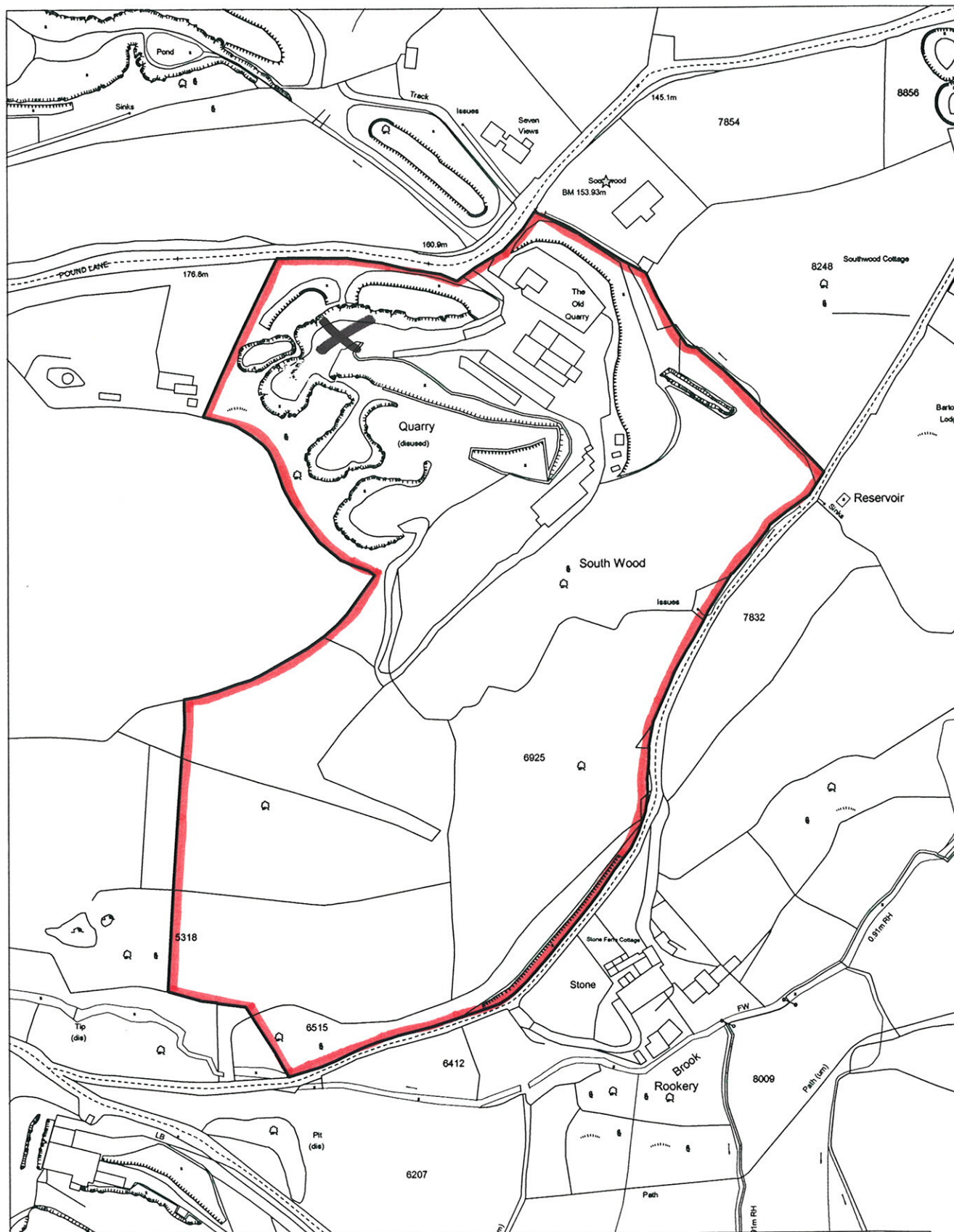

Reproduced from an Ordnance Survey map with the permission of the Controller of HMSO © Crown Copyright. Dartmoor National Park LA 08908L.