

Dated 31st August 2023

Section 119 Highways Act 1980

Dartmoor National Park Authority
Bridleway No.4 (Christow)
Footpath No.5 (Christow)

Public Path Diversion Order 2023

Section 119 Highways Act 1980

Dartmoor National Park Authority Bridleway No. 4 (Christow) Footpath No.5 (Christow) Public Path Diversion Order 2023

THIS ORDER is made by Dartmoor National Park Authority ('the Authority') under Section 119 of the Highways Act 1980 ('the 1980 Act') because it appears to the Authority that, in the interests of the owners of the land crossed by the bridleway described in paragraph 1 of this Order and the footpath described in paragraph 2 of this Order, it is expedient that the line of the bridleway and the footpath should be diverted.

The owners of the land have agreed to defray any compensation which becomes payable in consequence of the coming into force of this Order and pay any expenses which are incurred in bringing the site of the new bridleway and new footpath into a fit condition for use by the public.

Devon County Council, Teignbridge District Council and Natural England have been consulted, as required by Section 120(2) of the 1980 Act.

BY THIS ORDER

- 1 The public right of way over the land situated at Christow in the County of Devon and shown by a bold continuous line on the Order Map contained in this Order and described in Part 1A of the Schedule to this Order shall be extinguished after 28 days from the date of confirmation of this Order, or on such date as the Authority certifies that the work required to bring the new site of the footpath into a fit condition for use by the public has been carried out, whichever is the later.
- 2 The public right of way over the land situated at Christow in the County of Devon and shown by a bold continuous line on the Order Map contained in this Order and described in Part 1B of the Schedule to this Order shall be extinguished after 28 days from the date of confirmation of this Order, or on such date as the Authority certifies that the work required to bring the new site of the footpath into a fit condition for use by the public has been carried out, whichever is the later.
- 3 There shall, at the end of 28 days from the date of confirmation of this Order, be a public bridleway over the land situated at Christow in the County of

Devon as described in Part 2A of the Schedule and shown by a bold broken line on the Order Map contained in this Order.

- 4 There shall, at the end of 28 days from the date of confirmation of this Order, be a public footpath over the land situated at Christow in the County of Devon as described in Part 2B of the Schedule and shown by a bold broken line on the Order Map contained in this Order.

- 3 Where immediately before the date on which the said bridleway and footpath is diverted in pursuance of this Order there is apparatus in, on, over, along or across it belonging to statutory undertakers for the purpose of their undertakings, the statutory undertakers shall continue to have the same rights in respect of the apparatus as they would have had if this Order had never been made.

- 4 The rights conferred on the public under this Order shall be subject to the limitations and conditions set out in Part 3 of the Schedule hereto.

Schedule

Part 1A - Description of Site of Existing Bridleway

Section of Path or Way as Indicated on Order Map	Position	Approx Width
<p>A to B to C to D to E to F (544 metres)</p>	<p>From a point marked A on the Order Map (Grid Ref SX 8197 8477) the path proceeds in a generally south easterly direction to point B (Grid Ref SX 8209 8461). The path continues in a north-westerly direction to point C (Grid Ref SX8214 8465) and then in a south easterly direction to point D (Grid Ref SX 8220 8459). The path continues in a generally south easterly direction to points E (Grid Ref SX 8227 8459) and on to point F (Grid Ref SX 8238 8455)</p>	<p>The whole Width</p>

Part 1B - Description of Site of Existing Footpath

Section of Path or Way as Indicated on Order Map	Position	Approx Width
E to J (71 metres)	From a point marked E on the Order Map (Grid Reference SX 8227 8459) the path proceeds in a generally northerly direction to point J (Grid Reference SX 8231 8464).	The whole Width

Part 2A - Description of Site of New Bridleway

Section of Path or Way as Indicated on Order Map	Position	Width
G to H to J to K to F (491 metres)	From a point marked G on the Order Map (Grid Ref SX 8208 8485) the way proceeds in a generally south-easterly direction to point H (Grid Ref SX8220 8471). The way continues in a north-easterly and then south easterly direction to point J (Grid Ref SX8231 8464) and continues to point K (Grid Ref SX8239 8461). The way then proceeds in a southerly direction to join the existing bridleway at point F (Grid Ref SX 8238 8455).	The width is 3 metres

Part 2B - Description of Site of New Footpath

Section of Path or Way as Indicated on Order Map	Position	Width
D to L to J (123 metres)	From a point marked D on the Order Map (Grid Ref SX8220 8459) the path proceeds in a generally north-easterly direction to point L (Grid Ref SX8229 8464) and then continues to point J (Grid Ref SX8231 8464).	The width is 2 metres

Part 3A – Limitations and Conditions
New Bridleway

Position	Limitations and Conditions
Grid Ref SX8208 8485	A gate complying with BS 5709: 2018 and operable from horseback

Part 3B – Limitations and Conditions
New Footpath

Position	Limitations and Conditions
Grid Ref SX8220 8459	A gate complying with BS 5709: 2018
Grid Ref SX8229 8464	A gate complying with BS 5709: 2018

Dated this 31st day of August 2023

The Common Seal of)
Dartmoor National)
Park Authority)
was hereunto affixed)
in the presence of

Andrew Watson

Andrew Watson
(Head of Recreation, Access & Estates)

Document No: 817



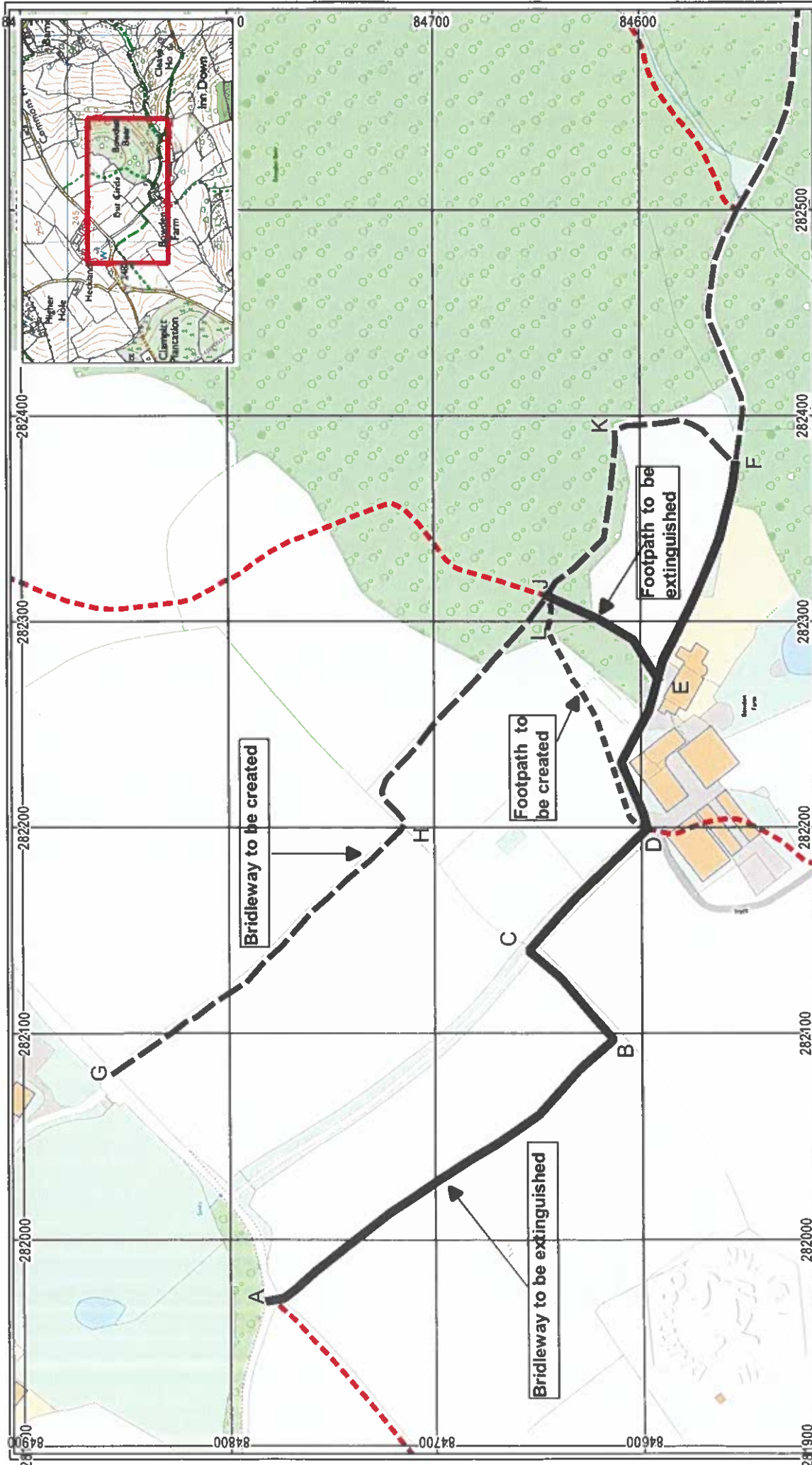

Map Center: SX 672 871
 Crown copyright and database rights Ordnance Survey 2023 100024842

Dartmoor National Park Authority
 Public Path Diversion Order 2023
 Bridleway 4 & Footpath 5 (Christow)

Notation:
 Bridleway to be extinguished (A-B-C-D-E-F) approx 544 metres
 Bridleway to be created (G-H-J-K-F) approx 491 metres
 Footpath to be extinguished (E-J) approx 71 metres
 Footpath to be created (D-L-J) approx 123 metres

Scale @ A4 1:2,500



Created on 26/05/2023
 Created by Andrew Watson

